

For swing gates with leafs up to 3 m.

Electromechanical gearmotor for external assembly. Available also in 24 Vdc version, with magnetic encoder. Ideal for residential use. New functional design and exclusive style.

New third generation models:

quality and durability thanks to the housing, made up of two tough aluminium shells with polyester paint finish; more resistant to atmospheric agents. Internal moving parts completely in steel, light alloys and technopolymers.

Reliable and silent: patented layout or internal parts.

Bronze lead screw for safe closure.

Simple installation and maintenance, with built-in capacitor.

Generously sized and practical connection compartment:

rapid and easy access from above to internal parts located in the upper section of the motor.

Total interchangeability with the series

Moby4000: identical positions and fixing brackets.

Recommended control units: Mindy A3, A3F, A6, A6F, A60, A700F; for TO4024 Mindy A824T.

24 Vdc version with magnetic encoder:

- simple programming of functions, by means of a single key
- clutch with anti-crush safety mechanism
- memorisation of limit positions on opening and closing in self-learning mode
- programming of pause time; pedestrian pass door, deceleration on opening and closing
- operation in the event of a power failure by means of rechargeable batteries

100% new!

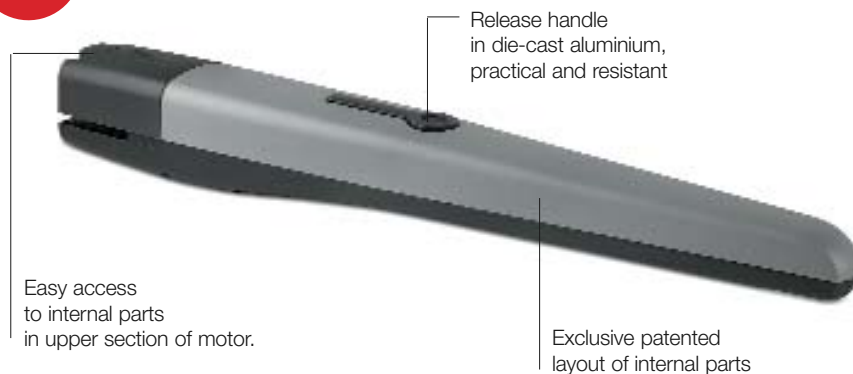

Code	Description	Pack/pallet
T04024	irreversible, 24 Vdc, with magnetic encoder, mechanical stop in opening	20
T04005	irreversible, 230 Vac, fast, with limit switch in opening	20
T04006	irreversible, 230 Vac, fast, with limit switch in opening and closing	20
T04015	irreversible, 230 Vac, slow, with limit switch in opening	20
T04605	reversible, 230 Vac, fast, with limit switch in opening	20

Technical specifications		T04024	T04005	T04006	T04015	T04605
Power	(Vac 50 Hz)	-				230
	(Vdc)	24				-
Max. absorption	(A)	5	1.5		1.3	
Nominal absorption	(A)	2	1		0.9	
Max. absorbed power	(W)	120	340		300	
Nominal absorbed power	(W)	60	180		160	
Built-in capacitor	(µF)	-	7			
Protection level	(IP)	44				
Speed under no load	(m/s)	0.016		0.013	0.016	
Speed under load	(m/s)	0.012		0.010	0.012	
Travel	(mm)	385	350		385	
Max. force	(N)	1800				
Nominal force	(N)	600				
Working temp.	(°C Min/Max)	-20 ÷ +50				
Thermal cut-out	(°C)	-	140			
Work cycle	(cycle/hour)	30		28	26	
Insulation class		A	F			
Dimensions	(mm)	820x115x105 h				
Weight	(kg)	6				

Utilisation limits

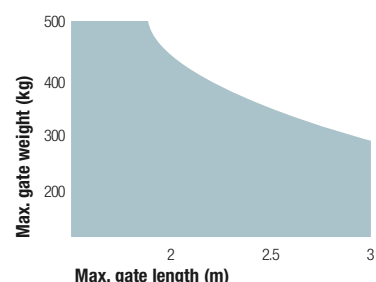

The shape, the height of the gate and the weather conditions can considerably reduce the values shown in the graph to the side. Use in windy areas 230 Vac models.

Nice Toona4

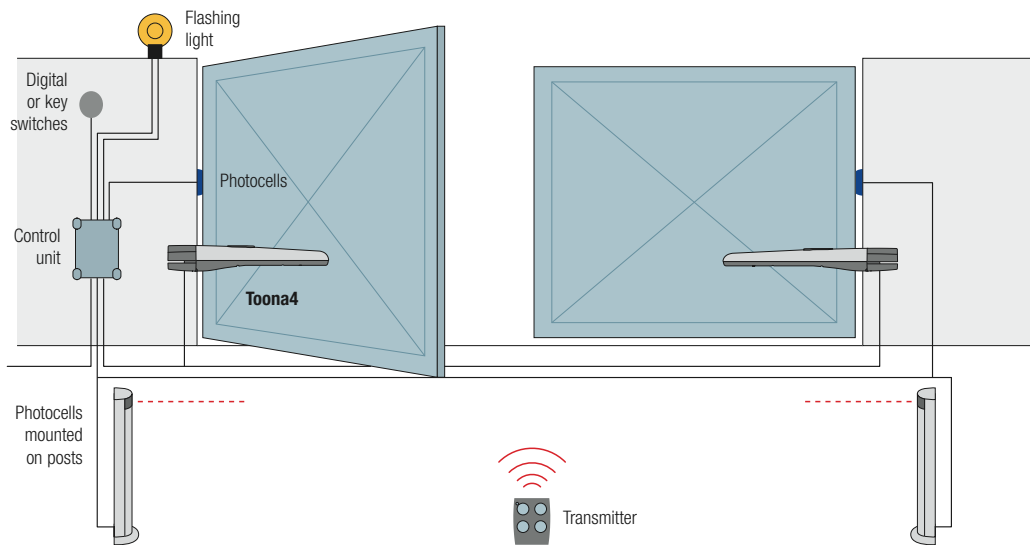

Accessories



PLA6
rear bracket
250 mm long
Pc./pack 1



PLA14
screw-adjustable
rear bracket
Pc./pack 2



PLA15
screw-adjustable
front bracket
Pc./pack 2



PLA10
vertical 12 V electric lock
(required for gates longer
than 3 m)
Pc./pack 1



PLA11
horizontal 12 V electric lock
(required for gates longer
than 3 m)
Pc./pack 1



PLA13
mechanical travel stops for
closing and opening manoeuvres
Pc./pack 4



TS
signboard
Pc./pack 1

Accessories for T04024



CARICA
plug-in card
for battery charger
Pc./pack 1



B12-B
12 V 6 Ah batteries
Pc./pack 1



B12V-C
12 V 2 Ah batteries
Pc./pack 1



BA3-A
Nice box for batteries

Approximate draft

The information shown in this publication is purely indicative. Nice reserves the right to make any modifications to the products as it sees fit.